

PARTS CATALOG

KM2V80

KIPOR

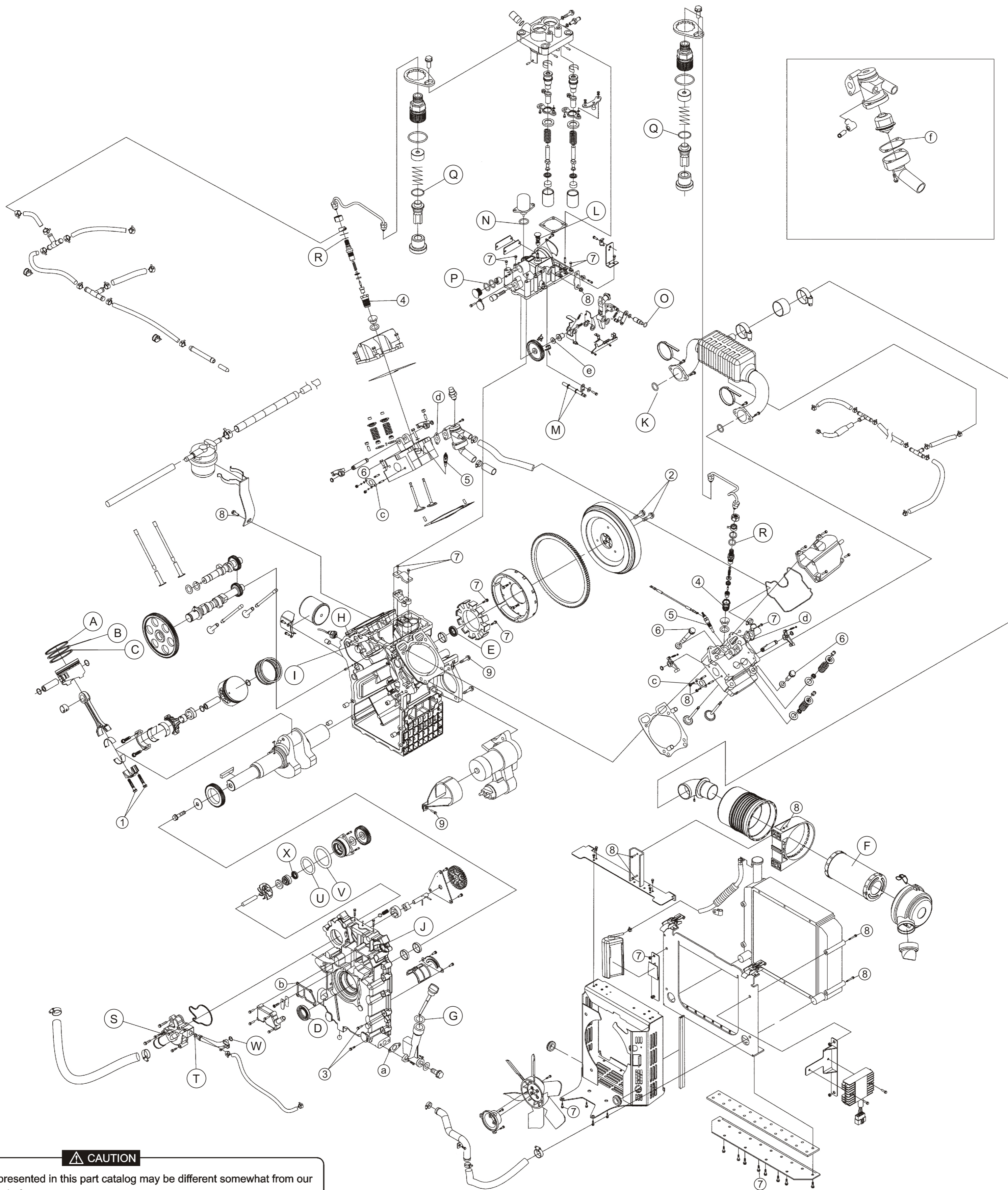

CAUTION

The structure presented in this part catalog may be different somewhat from our improved types in future.
Then You'd better refer parts catalog to the operation manual when using.

O-RING

| Ref.No | Part.No | Description | Qty. | Mounted to |
|--------|-----------------|-----------------|------|----------------------------------|
| G | GB/T1235-1976 | O-Ring 2.5×2.4 | 1 | (01) Cylinder Block Assembly |
| H | GB/T3452.1-1992 | O-Ring 5×1.8 | 2 | (01) Cylinder Block Assembly |
| I | GB/T3452.1-1992 | O-Ring 15.8×2.4 | 2 | (01) Cylinder Block Assembly |
| J | GB/T3452.1-1992 | O-Ring 23.6×1.8 | 1 | (01) Cylinder Block Assembly |
| K | GB/T3452.1-1992 | O-Ring 40×2.65 | 2 | (02) Cylinder Head Assembly |
| L | GB/T3452.1-1992 | O-Ring 10×1.8 | 1 | (11) Governor Assembly |
| M | GB/T3452.1-1992 | O-Ring 5×1.8 | 2 | (11) Governor Assembly |
| N | GB/T3452.1-1992 | O-Ring 28×1.8 | 1 | (11) Governor Assembly |
| O | GB/T3452.1-1992 | O-Ring 8.5×1.8 | 1 | (11) Governor Assembly |
| P | GB/T3452.1-1992 | O-Ring 18×1.8 | 2 | (11) Governor Assembly |
| Q | GB/T3452.1-1992 | O-Ring 16×2.65 | 2 | (12) Fuel Injector Pump Assembly |
| R | GB/T3452.1-1992 | O-Ring 10×1.8G | 2 | (13) Fuel Injector Assembly |
| S | GB/T3452.1-1992 | O-Ring 8.0×1.8 | 1 | (17) Cooling System |
| T | GB/T3452.1-1992 | O-Ring 16×2.65 | 2 | (17) Cooling System |
| U | GB/T3452.1-1992 | O-Ring 50×1.8 | 1 | (17) Cooling System |
| V | GB/T3452.1-1992 | O-Ring 54.5×1.8 | 1 | (17) Cooling System |
| W | GB/T3452.1-1992 | O-Ring 15.8×2.4 | 1 | (17) Cooling System |

OIL SEALS

| Ref.No | Part.No | Description | Qty. |
|--------|--------------|-------------------------------|------|
| X | KM2V80-17103 | Output Oil Seal of Crankshaft | 1 |

垫片组

| Ref.No | Part.No | Description | Qty. |
|--------|--------------|--------------------------------------|------|
| a | KM2V80-01013 | Oil Refilling Base Washer | 1 |
| b | KM2V80-01023 | Breather Cover Plate Washer | 1 |
| c | KM2V80-02017 | Exhaust Pipe Washer | 2 |
| d | KM2V80-02018 | Water Outlet Flange Washer | 2 |
| e | VE3-08-003 | Flyweight Base Washer | 2 |
| f | KM2V80-17204 | Thermal-regulator Shell Cover Washer | 1 |

EASY DESTROYED PARTS

| Ref.No | Part.No | Description | Qty. | Mounted to |
|--------|--------------|---------------------------------|------|---------------------------------------|
| A | KM2V80-04001 | First Air Ring | 2 | (04) Piston & Connecting Rod Assembly |
| B | KM2V80-04002 | Second Air Ring | 2 | (04) Piston & Connecting Rod Assembly |
| C | KM2V80-04100 | Oil Ring Assembly | 2 | (04) Piston & Connecting Rod Assembly |
| D | KM2V80-01018 | Output Oil Seal of Crankshaft | 1 | (01) Cylinder Block Assembly |
| E | KM2V80-01019 | Flywheel Oil Seal of Crankshaft | 1 | (01) Cylinder Block Assembly |
| F | KM2V80-07300 | Air Element Unit | 1 | (07) Air Intake System |

FASTENING TORQUE OF MAIN BOLT & NUT (Unit:N.m)

| Ref.No | Description | Qty. |
|--------|----------------------------|--------------------|
| ① | Connecting Rod Bolt | 28±2 |
| ② | Flywheel Bolt | 80±5 |
| ③ | Cylinder Cover Bolt | 25 ^{±0.5} |
| ④ | Fuel Injector Screw Thread | 60±10 |
| ⑤ | Electro-thermal Plug | 12±2 |
| ⑥ | Cylinder Head Bolt | 70±5 |
| ⑦ | Standard M6 Bolt (Nut) | 10 ^{±0.5} |
| ⑧ | Standard M8 Bolt (Nut) | 23 ^{±0.5} |
| ⑨ | Standard M10 Bolt (Nut) | 45 ^{±0.5} |

