

Exploded parts list

Industrial Generator

HY4102 Engine - DHY28KSEm / DHY28KE / DHY28KSE / DHY34KE / DHY34KSE

ENGINE- CYLINDER BLOCK(1) HY4102-A

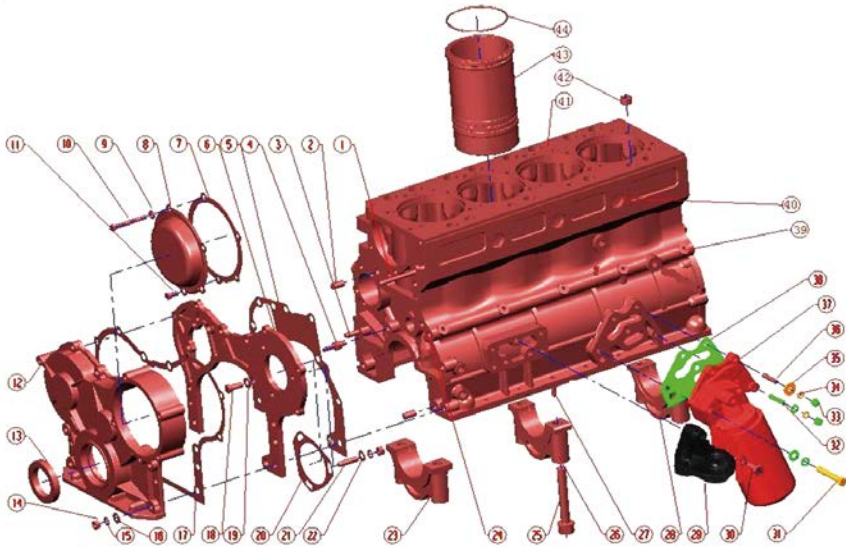

POS	REF	DESCRIPTION	配件	QTY	
				1500RPM	1800RPM
1	Q1200870F3S	Stud	双头螺柱	1	1
2	Q5211224	Straight pin	圆柱销	2	2
3	Q1200845F3S	Stud	双头螺柱	3	3
4	1002023_M	Jet	喷嘴	1	1
5	1002072-3_M	Gasket,gear case to block	齿轮室底板垫片	1	1
6	1002071_MD	Gear case	齿轮室底板	1	1
7	1002077-2_M	Gasket advance device cover	提前器盖垫片	1	1
8	1002076-2_M	Advance device cover	提前器盖	1	1
9	Q40108	Washer	平垫圈	3	3
10	Q150B0865	Hexagon headed bolt	六角头螺栓	3	3
11	Q150B0612	Hexagon headed bolt	六角头螺栓	2	2
	Q150B0812	Hexagon headed bolt	六角头螺栓	1	1
12	1002073-3_M	Gear casing	齿轮室	1	1
13	1005050_M	Oil seal front	前油封	1	1
14	Q340B10	Hexagon nut,style I	I型六角螺母	5	5
15	Q40310	Spring washer	弹簧垫圈	5	5
16	Q40110	Washer	平垫圈	5	5
17	1002074-3_M	Gasket,cover to gear case	齿轮室垫片	1	1
18	Q150B1025	Hexagon headed bolt	六角头螺栓	3	3
19	Q40110	Washer	平垫圈	3	3
20	1111012_MD	Gasket	喷油泵连接盘垫片	1	1
21	Q1201025F3S	Stud	双头螺柱	3	3
22	Q40410	Spring washer,light style	轻型弹簧垫圈	3	3
23	1005141-1_M	Main bearing cap,front	前主轴承盖	1	1
24	1002232-2_M	plug	堵塞	2	2
25	1005144_M	Main bearing bolt	主轴承盖螺栓	10	10
26	1005142-1_M	Main bearing cap,middle	中间主轴承盖	3	3
27	Q1200816	Stud	双头螺柱	0	0
28	1005143-1_M	Main bearing cap,rear	后主轴承盖	1	1
29	1001010_H	stand bar	支撑	1	1
30	Q150B1025	Hexagon headed bolt	六角头螺栓	0	0
31	Q150B1070	Hexagon headed bolt	六角头螺栓	2	2
32	Q120B0835	Stud	螺柱	1	1
33	Q341B08	Hexagon nut,style I	螺母M8	3	3
34	Q40110	Washer	垫圈10	4	4
35	Q40108	Washer	垫圈8	2	2
36	Q120B0838	Stud	螺柱	2	2
37	1012010-3_M	Lubricating oil filter assy	机油滤清器总成	1	1
38	1002032_M	Gasket,oil filter connecting plate	机油滤连接板垫片	1	1
39	1002013Y_M	plug	堵塞	5	5
40	1002231_M	Bowl-shaped plug plate	碗形塞片	4	4
41	1002014-2_BM	Cylinder block	气缸体	1	1
42	1002011_M	Cylinder head locating sleeve	气缸盖定位套	2	2
43	1002016-1_M	Cylinder liner	气缸套	4	4
	1002016_BM				
44	1002017_M	Water sealed ring	水封圈	8	8
	1002017_BM				

ENGINE- CYLINDER BLOCK(2) HY4102-A

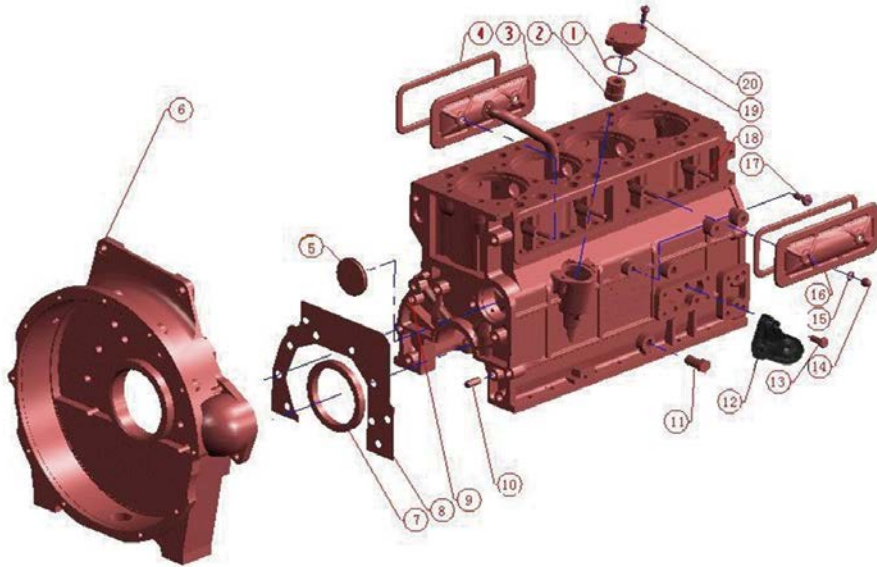

POS	REF	DESCRIPTION	配件	QTY	
				1500RPM	1800RPM
1	1002042-1_M	Gasket	机油泵上轴套盖垫片	1	1
2	1002044-1_M	Bush,oil pump drive gear shaft	机油泵传动轴衬套	1	1
3	1002095L_M	Rear side cover	后上侧盖板焊合件	1	1
4	1002098-1_M	Gasket,side cover	上侧盖板垫片	2	2
5	1002234-2_M	Plug	堵盖-凸轮轴衬套	1	1
6	1002061_MD	Flywheel housing	飞轮壳	1	1
	1002068-1_M	Flywheel housing rubber plug	飞轮壳橡胶堵塞	1	1
7	1005060-1_M	Oil seal,rear	后油封	1	1
8	1002064-4_M	Gasket,flywheel housing	飞轮壳垫片	1	1
9	1002232-2_M	Plug	堵塞	1	1
10	Q5211224	Dowel pin	圆柱销	2	2
11	Q617B16	Hexagon headed plug	六角头螺塞	1	1
12	1001010_H	stand bar	支撑	1	1
13	Q150B1025	Hexagon headed bolt	六角头螺栓	0	0
14	Q394B08	Cap Nut	盖形螺母	4	4
15	Q40308	Spring washer	弹簧垫圈	4	4
16	1002092L_M	Side cover,front	前上侧盖板	1	1
17	Q617B16	Hexagon headed plug	六角头螺塞	1	1
18	Q1200830F3S	Stud	双头螺柱	4	4
19	1002041-2_M	Cover for lube,oil pump	机油泵上轴套盖	1	1
20	Q150B0825	Hexagon headed bolt	六角头螺栓	2	2

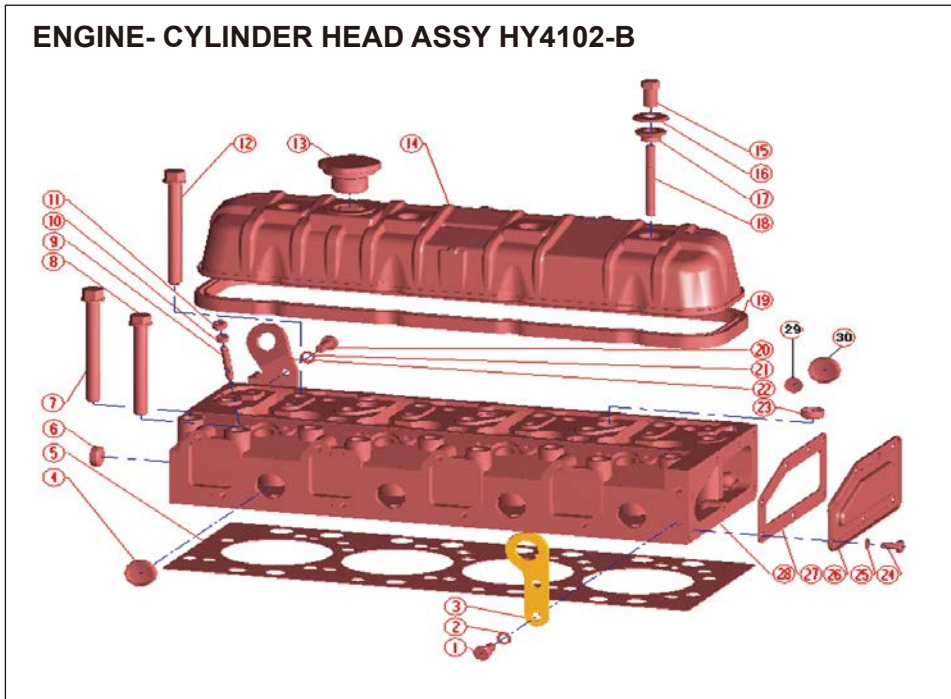

POS	REF	DESCRIPTION	配件	QTY	
				1500RPM	1800RPM
1	Q150B1020	Hexagon headed bolt	六角头螺栓	2	2
2	Q40308	Spring washer	弹簧垫圈	2	2
3	1003058-3_M	Eye plate,rear	后吊耳	1	1
4	1002231/W	Bowl-shaped plug plate	碗形塞片	7	7
5	1003022-2_M	Cylinder head gasket assy	气缸垫总成	1	1
6	1003093/W	Bowl-shaped plug,plate	碗形塞片	5	5
7	1003049_M	Cylinder head bolt,middle	气缸盖中螺栓	10	10
8	1003047_M	Cylinder head bolt,short	气缸盖短螺栓	4	4
9	Q1200845	Stud	双头螺柱	8	8
10	Q40308	Spring washer	弹簧垫圈	8	8
11	Q341B08	Hexagon Nut,style I	I型六角螺母	8	8
12	1003046_M	Cylinder head bolt,long	气缸盖长螺栓	4	4
13	1003033-2/W	Oil filler cover	加机油口盖	1	1
	GB3452.1-1992(31.5*3.55)	"O"ring 31.5*3.55	O型密封圈31.5*3.55	1	1
14	1003030-3_M	Cylinder head cover assy	气缸盖罩总成	1	1
15	Q394B10	Cap Nut	盖形螺母	4	4
16	Q40110	Washer	平垫圈	4	4
17	1003034-1_Q	Washer	组合垫圈	4	4
18	1003016-2_M	Stud	双头螺柱(涂胶)	4	4
19	1003032-1_Q	Rubber sealing gasket-Cylinderhead cover	垫密条-气缸盖罩	1	1
20	Q150B1025	Hexagon headed bolt	六角头螺栓	2	2
21	Q40310	Spring washer	弹簧垫圈	2	2
22	1003057-2_M	Eye plate,front	前吊耳	1	1
23	34	Bowl-shaped plug plate	碗形塞片	3	3
24	Q150B0820	Hexagon headed bolt	六角头螺栓	4	4
25	Q40308	Spring washer	弹簧垫圈	7	7
26	1003012_M	Rear cover of cylinder head	气缸盖后盖	7	7
27	1003013_M	Gasket of rear cover	后盖板垫片	1	1
28	1003011-2_M	Cylinder head	气缸盖	1	1
29	1003092_M	Bowl-shaped plug plate	堵塞(1)	3	3
30	1003093_M	Bowl-shaped plug plate	堵塞(2)	4	4

ENGINE- PISTON AND CONNECTING ROD HY4102-C

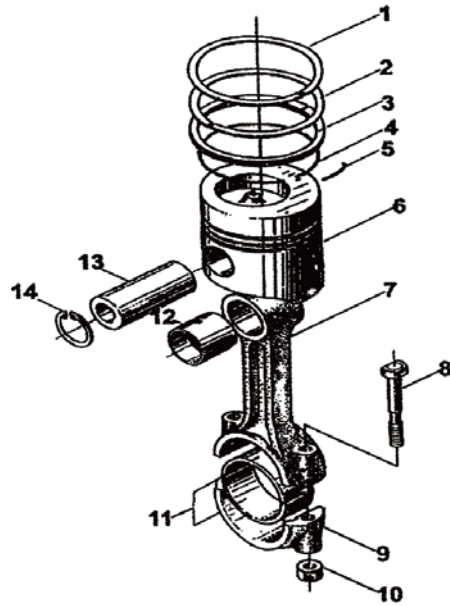

POS	REF	DESCRIPTION	配件	QTY	
				1500RPM	1800RPM
1	1004012_BM	Comperssion ring (1)	第一道气环	4	4
2	1004013_BM	Comperssion ring (2)	第二道气环	4	4
3	1004014_BM	Oil ring	油环体	4	4
4	1004016_BM	Oil ring spring	螺旋撑簧	4	4
5	1004017_BM	Locking pin	门销	4	4
6	1004011-3_BM	Piston	活塞	4	4
7	1004021_AM	Connecting rod body	连杆体	4	4
8	1004023-1_AM	Connecting rod bolt	连杆螺栓	8	8
9	1004022_AM	Connecting rod cap	连杆盖	4	4
10	1004024_M	Connecting rod nut	连杆螺母	4	4
11	1004026_M	Connecting rod bearing	连杆轴瓦	8	8
12	1004026_AM 1004027_AM	Connecting rod small end bush	连杆小头衬套	8	8
13	1004018_BM	Piston pin	活塞销	4	4
14	GB893.1-1986	Internal snap ring	挡圈35	8	8

ENGINE- CRANKSHAFT AND FLYWHEEL HY4102-D

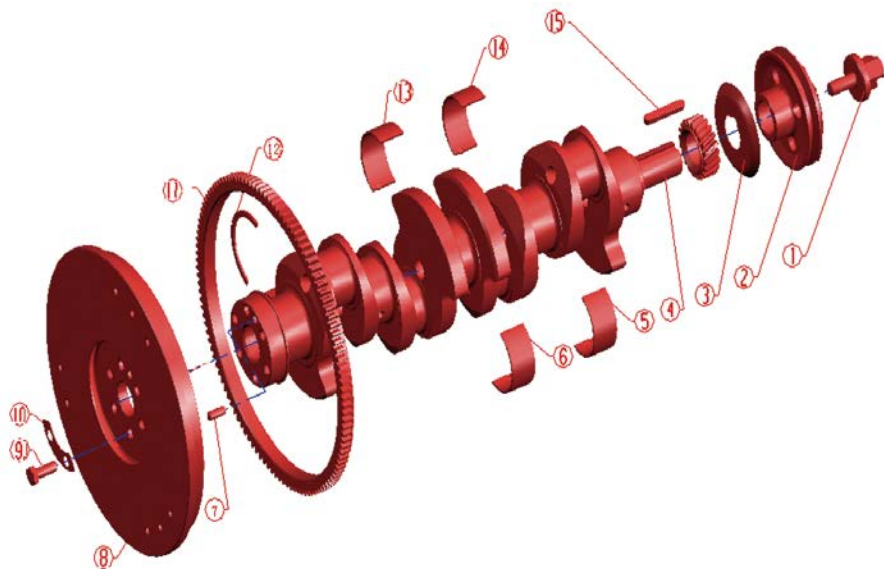

POS	REF	DESCRIPTION	配件	QTY	
				1500RPM	1800RPM
1	1005044-1_M	Starting bolt	起动螺栓	1	1
2	1005046_MD	Pulley	曲轴皮带轮	1	1
3	1005036_M	Oil retainerdisc,front	前挡油盘	1	1
4	1005014_AMY-11	Crankshaft	曲轴	1	1
5	1005162_AM	Botton half,front and rear main bearing	前后主轴瓦(下)	2	2
6	1005172_AM	Botton half,middle main bearing	中间主轴瓦(下)	3	3
7	Q5221024	Dowel pin	圆柱销	1	1
8	1005121_MD	Flywheel	飞轮	1	1
9	1005123_QZL	Flywheel bolt	飞轮螺栓	6	6
10	1005124_MY-06	Lock plate	防松垫片	3	3
11	1005122_M	Ring gear-flywheel	齿环-飞轮	1	1
12	1005181-2_M	Thrust plate	上止推片	2	2
	1005181_M	Thrust plate	下止推片	2	2
13	1005171_AM	Top half,middle main bearing	中间主轴瓦(上)	3	3
14	1005161_AM	Top half,front and rear main bearing	前后主轴瓦(上)	2	2
15	GB1096-1979	Key C10x56	键C10X56	1	1

ENGINE - CAMSHAFT ASSY HY4102-E

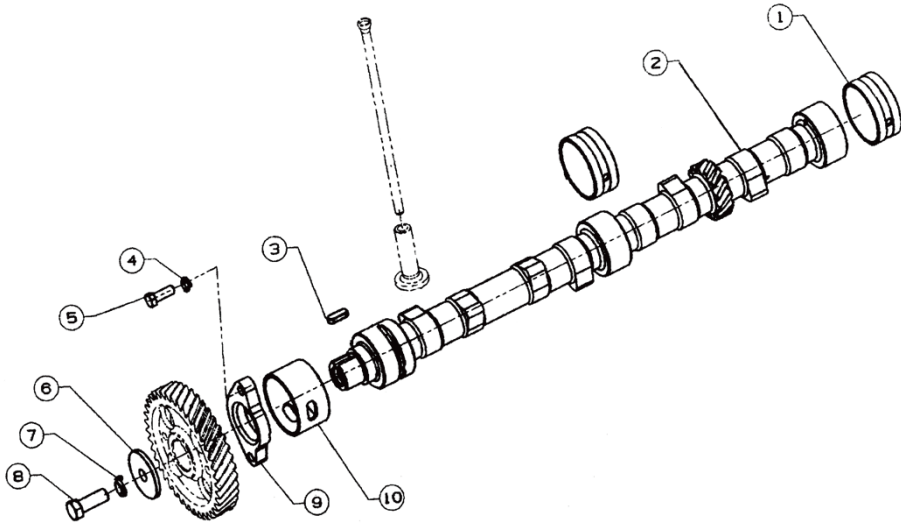

POS	REF	DESCRIPTION	配件	QTY	
				1500RPM	1800RPM
1	1006028-3_M	Bushing(II,III) of camshaft	凸轮轴衬套 (II , III)	2	2
2	1006015-2_M	Camshaft	凸轮轴	1	1
3	GB1096-1979	Key 8X22	键8X22	1	1
4	Q40308	Spring washer	弹簧垫圈	2	2
5	Q150B0825	Hexagon-headed bolt	六角头螺栓	2	2
6	1006022-1_M	Press plate of timing gear,camshaft	凸轮轴正时齿轮压板	1	1
7	Q40108	Washer	平垫圈	1	1
8	Q150B0830	Hexagon-headed bolt	六角头螺栓	1	1
9	1006018_M	Press plate,camshaft	凸轮轴压板	1	1
10	1006024-3_M	Bushing(I) of camshaf	凸轮轴衬套 (I)	1	1

ENGINE - VALVE TRAIN HY4102-F

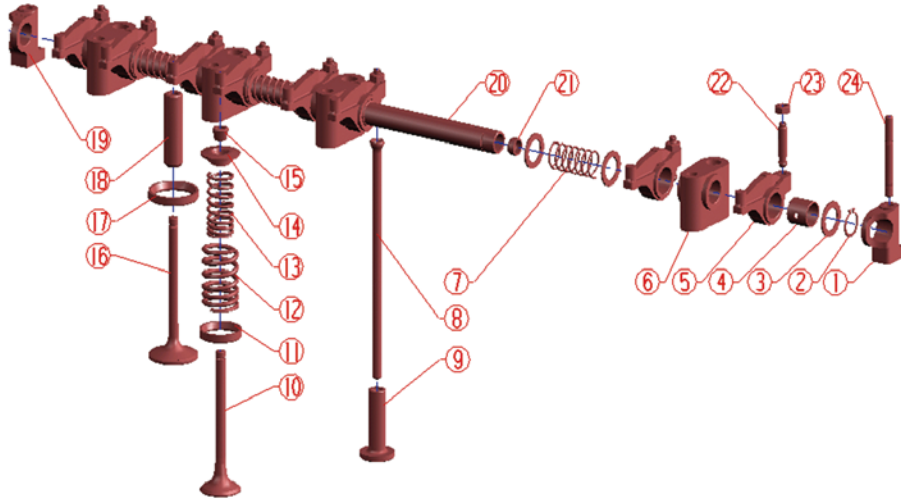

POS	REF	DESCRIPTION	配件	QTY	
				1500RPM	1800RPM
1	1007126_M	Rear bracket,rocker arm shaft	后辅助摇臂座	1	1
2	Q43120	Circlip for shaft	轴用弹性挡圈	2	2
3	1007093_M	Washer	垫圈	8	8
4	1007094-1_M	Bushing,rocker arm	气门摇臂衬套	8	8
5	1007096_M	Rocker arm	气门摇臂	8	8
6	1007127_M	Rocker arm shaft bracket	摇臂座	4	4
7	1007114_M	Spring of rocker arm shaft	气门摇臂轴弹簧	3	3
8	1007051-1_AM	Push rod	推杆	8	8
9	1007061_M	Tappet	挺柱	8	8
10	1007016_M	Exhaust valve	排气门	4	4
11	1007081_M	Seat insert,exhaust valve	排气门座	4	4
12	1007021_M	Outer spring of valve	气门外弹簧	8	8
13	1007022_M	Inter spring of valve	气门内弹簧	8	8
14	1007024-1_M	Valve spring seat	气门弹簧座	8	8
15	1007028_M	Valve split collet	气门夹锁	16	16
16	1007011_M	Intake valve	进气门	4	4
17	1007082_M	Seat insert,inlet valve	进气门座	4	4
18	1007032_M	Valve guiding pipe	气门导管	8	8
19	1007125_M	Front bracket,rocker arm shaft	前辅助摇臂座	1	1
20	1007091-1_M	Rocker arm shaft	摇臂轴	1	1
21	1007092_M	Plug	碗形塞	2	2
22	1007097_M	Adjusting screw,rocker arm	气门间隙调节螺钉	8	8
23	Q341B08	Hexagon nut,style I	I型六角薄螺母	8	8
24	Q1200860	Stud	双头螺柱	2	2

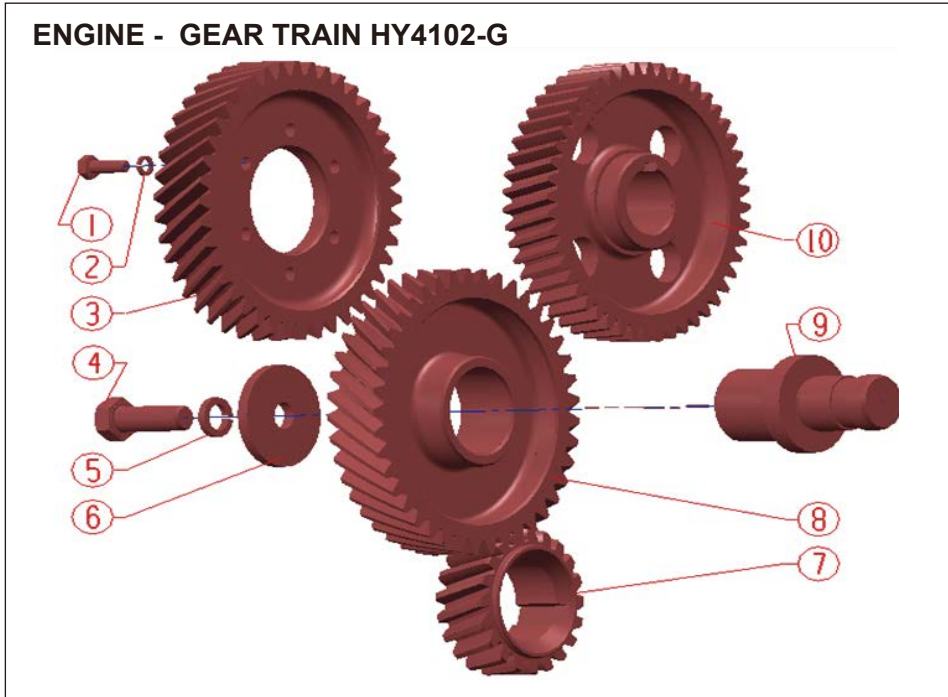

POS	REF	DESCRIPTION	配件	QTY	
				1500RPM	1800RPM
1	Q150B0616	Hexagon headed bolt	六角头螺栓	6	6
2	Q40306	Spring washer	弹簧垫圈	6	6
3	1111216-1_M	Fuel injection pump drive gear	传动齿轮-喷油泵	1	1
4	Q150B0820	Hexagon headed bolt	六角头螺栓	1	1
5	Q40108	Washer	平垫圈	1	1
6	1006049-1_M	Baffle,idle gear	正时惰齿轮压板	1	1
7	1005084_M	Timing gear,crankshaft	曲轴正时齿轮	1	1
8	1006045-1_M	Timing idle gear	正时惰齿轮	1	1
9	1006048-1_M	Idle gear shaft	正时惰齿轮轴	1	1
10	1006021-2_M	Timing gear of camshaft	凸轮轴正时齿轮	1	1

ENGINE - INTAKE AND EXHAUST MANIFOLD ASSY HY4102-H

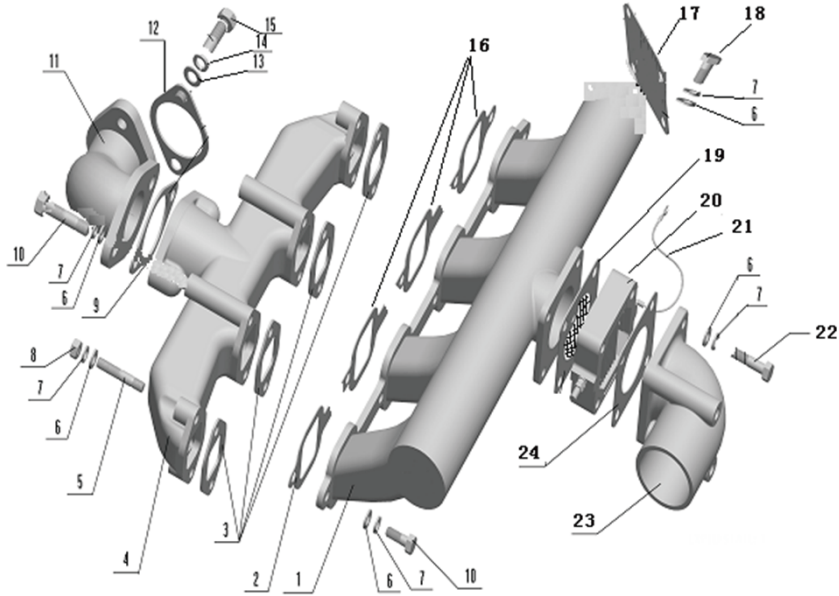

POS	REF	DESCRIPTION	配件	QTY	
				1500RPM	1800RPM
1	1008016_MD	Intake manifold	进气管	1	1
2	1008017-1_M	Gasket,intake manifold	进气管垫片	1	1
3	1008045_M	Gasket,exhaust bolt	排气管垫片	4	4
4	1008042_MY-06	Exhaust manifold	排气管	1	1
5	Q1200830	Stud	双头螺柱	8	8
6	Q40108	Washer	平垫圈	28	28
7	Q40408	Spring washer,light style	轻型弹簧垫圈	28	28
8	Q34108	Hexagon nut,style I	I型六角螺母	8	8
9	1008046_MY-06	Gasket	排气接管垫片	1	1
10	Q150B0820	Hexagon-headed bolt	六角头螺栓	12	12
11	1008043_MD	Exhaust connecting pipe	排气接管	1	1
12	1008046-1/W	Gasket	排气总管垫片	1	1
13	Q40110	Washer	平垫圈	2	2
14	Q40410	Spring washer,light style	轻型弹簧垫圈	2	2
15	Q150B1025	Hexagon-headed bolt	六角头螺栓	2	2
16	1008017-2_M	Gasket,intake manifold	进气管垫片	3	3
17	1008021/WK	cover	盖板	1	1
18	Q150B0816	Hexagon-headed bolt	六角头螺栓	4	4
19	3750011_BWB-41	Block graticule	挡网	1	1
20	3750010_BWB-41	Air boiler	空气加热器	1	1
21	3750020/WA1-04	Earth wire of air boiler	空气加热器接地线	1	1
22	Q150B0845	Hexagon-headed bolt	六角头螺栓	4	4
23	1008017-3_WK	Intake connecting pipe	进气接管	1	1
24	1008019_MD	Gasket, Intake connecting pipe	进气接管垫片	2	2

ENGINE - OIL SUMP ASSY HY4102-I

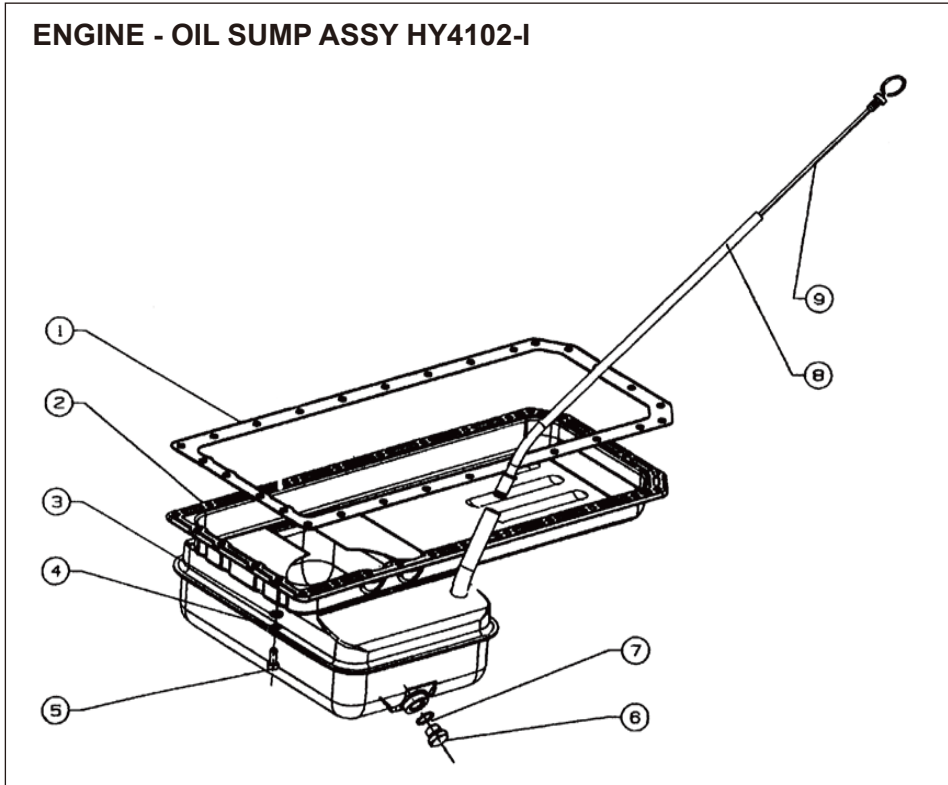

POS	REF	DESCRIPTION	配件	QTY	
				1500RPM	1800RPM
1	1009031-1_M	Oil sump gasket	油底壳密封垫片	1	1
2	1009010-3_MY-17	Oil sump assy	油底壳总成	1	1
3	Q40108	Washer	平垫圈	28	28
4	Q40408	Spring washer,light style	轻型弹簧垫圈	28	28
5	Q150B0816	Hexagon-headed bolt	六角头螺栓	28	28
6	1009023_M	Oil drain plug-oil sump	油底壳放油螺塞	1	1
7	Q72318	Washer	垫圈	1	1
8	1009060-5_M	Dipstick tube	上机油标尺管	1	1
	1009060-1_M				
9	1009070_MY-17	Oil dipstick assy	机油标尺总成	1	1

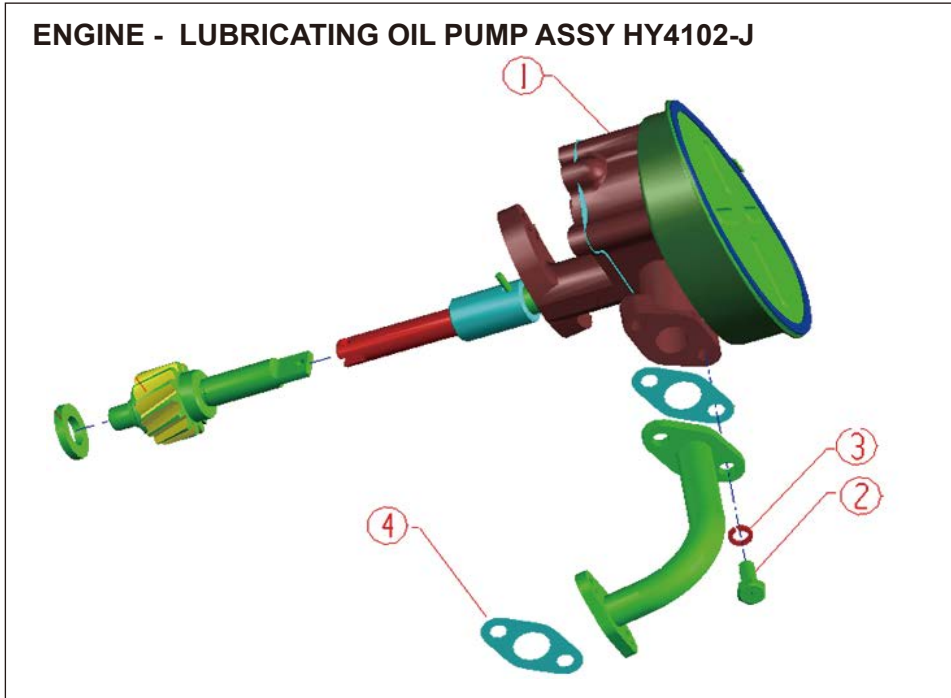

POS	REF	DESCRIPTION	配件	QTY	
				1500RPM	1800RPM
1	1011010_M-02	Pump body	机油泵	1	1
2	Q150B0820	Hexagon headed bolt	六角头螺栓	4	4
3	Q40108	Washer	平垫圈	4	4
4	1011011-1_M	Gasket	垫片	1	1

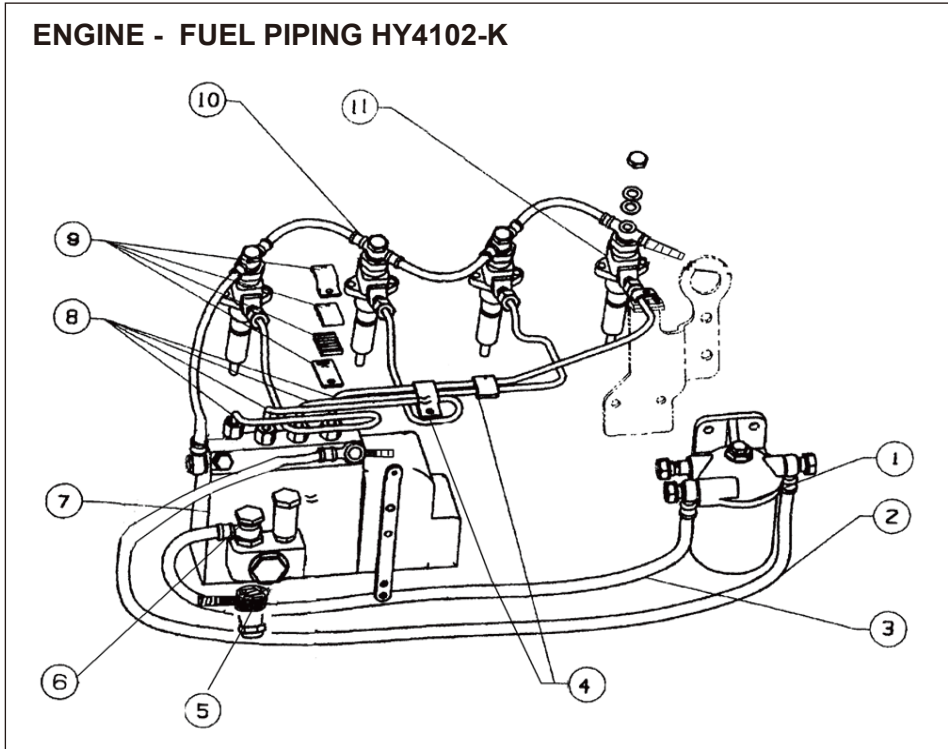

POS	REF	DESCRIPTION	配件	QTY	
				1500RPM	1800RPM
1	1117000-2_M	Fuel Filter assy	燃油滤清器总成	1	1
2	1104040_BWA-09	Fuel deliner flexible pipe assy	燃油管总成-柴滤至喷油泵	1	1
3	1104030_QS	Fuel deliner flexible pipe assy	燃油管总成-输油泵至柴滤	1	1
4	1129040_M	High pressure fuel pipe clamp(一)	高压油管夹子(一)	1	1
5	1111107_BW	Fuel intake pipe connector	进油管接头体-油泵	1	1
6	Q/XC3451.1-2002	Hollow screw M14x1.5	铰接螺栓M14x1.5	2	2
7	1111000W_M33D	Fuel injection pump assy	喷油泵总成	1	1
8	1129010/15/20/25_BMD	High pressure fule pipe clamp assy(二)	高压油管总成	1	1
9	1104050_BML-01	Fuel injector leak-off pipe clamp	喷油体回油管总成	1	1
10	1112000S_BM	Fuel injector	喷油器总成	4	4

ENGINE - FUEL INJECTION PUMP HY4102-L

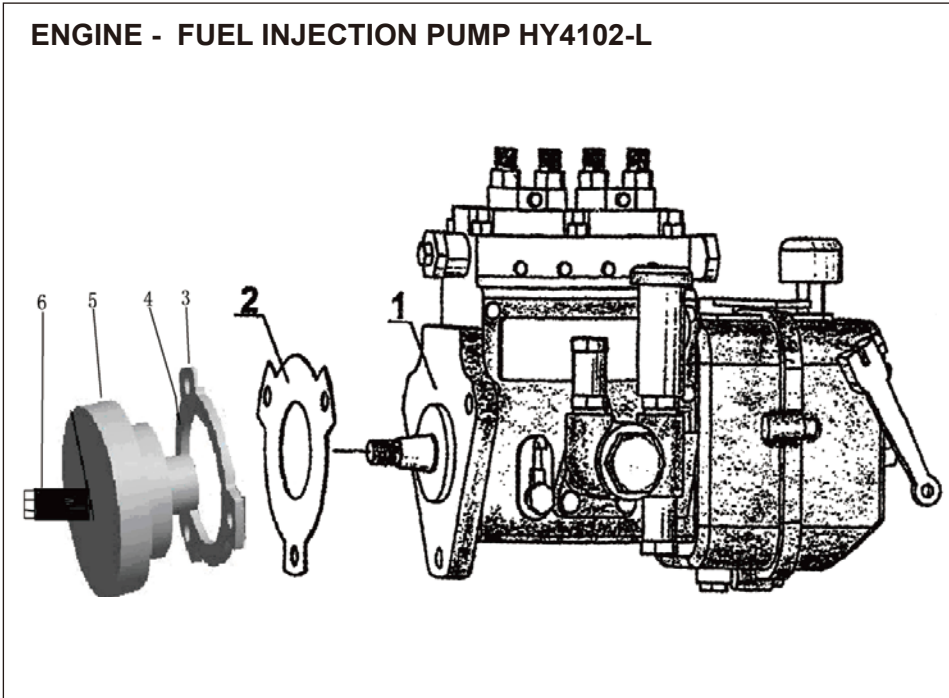

POS	REF	DESCRIPTION	配件	QTY	
				1500RPM	1800RPM
1	1111000_MD	Fuel injection pump assy	喷油泵总成	1	1
2	1111014/WA	Gasket	喷油泵法兰垫片	1	1
3	1111011_MD	Gasket	喷油泵垫块	1	1
4	1111012_MD	Gasket	喷油泵连接盘垫片	1	1
5	1111013_MD	Fuel injection pump timing gear connector	喷油泵正时齿轮连接盘	1	1
6	1111014_MD	Fuel injection pump camshaft nut	油泵凸轮轴螺母	1	1

ENGINE - FUEL INJECTOR HY4102-M

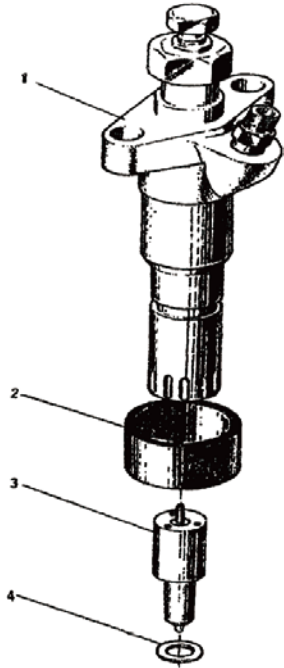

POS	REF	DESCRIPTION	配件	QTY	
				1500RPM	1800RPM
1	1112000S_BM	Fuel injector assy	喷油器总成	4	4
2	1003056_MZ1	Copper sleeve	喷油器铜套	4	4
3	1112020_BM	Needle valve element	喷油器针阀偶件	4	4
4	1112308_6F	Washer	喷油器垫片	4	4

ENGINE - FAN AND COOLING WATER PUMP ASSY HY4102-N

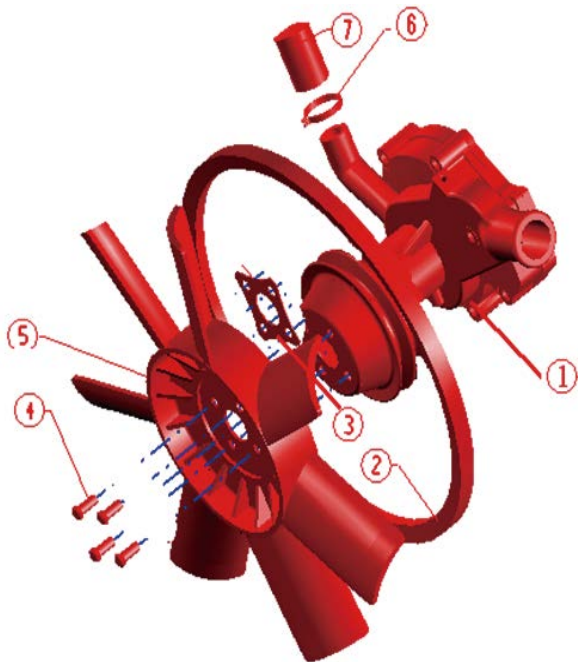

POS	REF	DESCRIPTION	配件	QTY	
				1500RPM	1800RPM
1	1307010_MD	water pump	水泵	1	1
	1307013_BM	Gasket,water pump	水泵垫片	1	1
2	1308032_MD	fan belt	风扇皮带	1	1
3	1308047_BMY-13P	Gasket	风扇皮带轮垫	1	1
4	Q150B0816	Hexagon headed bolt	六角头螺栓	4	4
	Q40308	Spring washer	弹簧垫圈	4	4
	Q40108	Washer	平垫圈	4	4
5	1308010_AMD	Fan	风扇总成	1	1
6	Q67632	Hoop	环箍	1	1
7	2501001-1_BML-02B	water preheater return pipe cover	回水口盖	1	1

ENGINE - THERMOSTAT & WATER DRAINCOCK ASSY HY4102-O

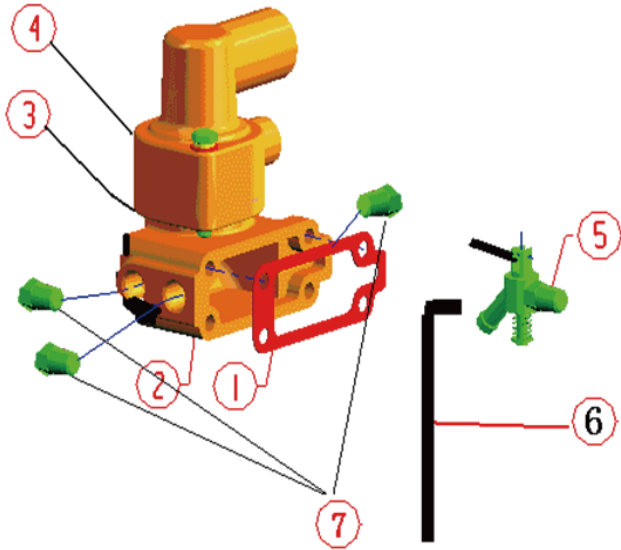

POS	REF	DESCRIPTION	配件	QTY	
				1500RPM	1800RPM
1	1306012_M	Gasket,Thermostat housing	节温器壳垫片	1	1
2	1306011-1_M	Thermostat housing	节温器壳	1	1
3	1306014_M	Gasket,thermostat cover	节温器盖垫片	1	1
4	1306013-2_M	Thermostat cover	节温器盖	1	1
5	1305010_H	Water drain assy	放水开关总成	1	1
6	1305018_H	rubber pipe, water drain assy	放水开关出水橡胶管	1	1
7	Q618B03	Hexagon tapered screw plug	六角头锥形螺塞	1	1

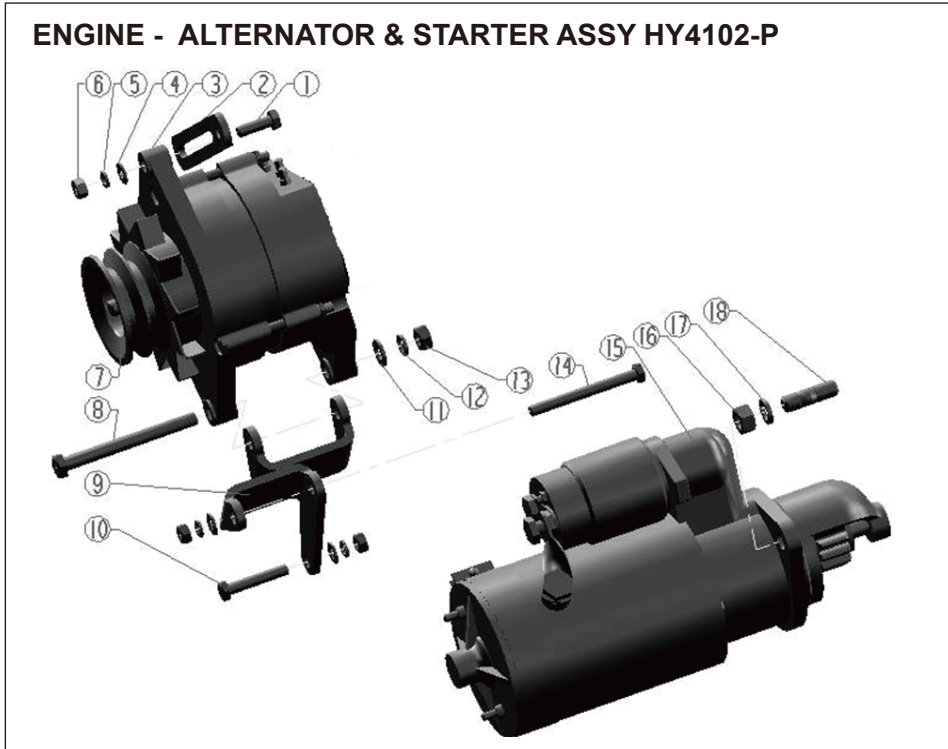

POS	REF	DESCRIPTION	配件	QTY	
				1500RPM	1800RPM
1	Q150B0822	Hexagon headed bolt	六角头螺栓	1	1
2	3701325-1_M	Connecting plate	连接板	1	1
	3701101/W	Washer	垫圈	1	1
3	3701010-2_M	Generator assy	发电机总成	1	1
4	Q40108	Washer	平垫圈	3	3
5	Q40308	Spring washer	弹簧垫圈	3	3
6	Q340B08	Hexagon nut,style I	I型六角螺母	3	3
7	3701010_MZL-02	generator	发电机总成	1	1
8	Q150B10130T F2	Hexagon headed bolt	六角头螺栓	1	1
9	3701320-2_M	Generator bracket weld assy	发电机支架总成	1	1
10	Q150B0845	Hexagon beaded bolt	六角头螺栓	1	1
11	Q40108	Washer	平垫圈	2	2
12	Q40308	Spring washer	弹簧垫圈	2	2
13	Q340B08	Hexagon nut,style I	I型六角螺母	2	2
14	Q150B0880	Hexagon headed bolt	六角头螺栓	1	1
15	3708010-2_M	Starter assy	起动机总成	1	1
16	Q340B12	Hexagon nut,style I	I型六角螺母	2	2
17	Q40312	Spring Washer	弹簧垫圈	2	2
18	Q1201225F3S	Stud	双头螺栓	2	2

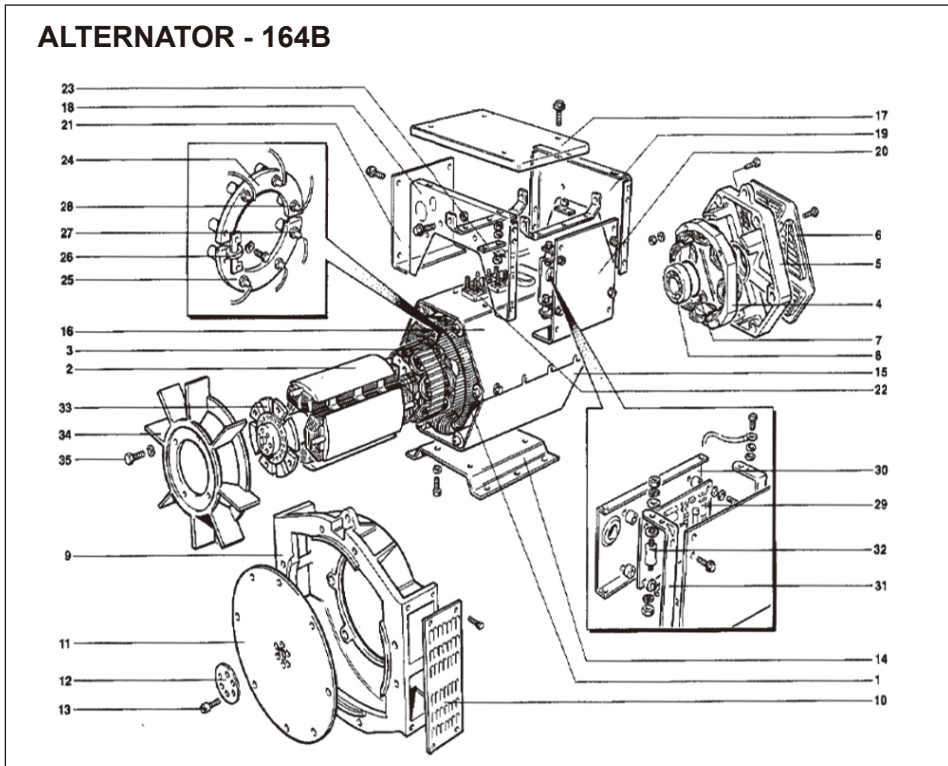

164B-36

POS	REF	DESCRIPTION	配件	QTY
1	164B-1	Stator	定子	1
2	164B-2	Rotor	转子	1
3	164B-3	Exciter Rotor	励磁转子	1
4	164B-4	Exciter Stator	励磁定子	1
5	164B-5	N.D.E.Endbracket	后盖	1
6	164B-6	Cover N.D.E.	塑料后罩	1
7	164B-7	Bearing 'O'Ring N.D.E.	轴承O型圈	1
8	164B-8	Bearing N.D.E.	轴承	1
9	164B-9	D.E. Adaptor	接套	1
10	164B-10	D.E. Screen	接套防护罩	2
11	164B-11	Coupling Hub	SAE盘片	1
12	164B-12	Pressure Plate	盘片压板	1
13	164B-13	Coupling Bolt	SAE盘片螺栓	6
14	164B-14	Foot	底脚板	1
15	164B-15	Frame Cover Bottom	电机底壳	1
16	164B-16	Frame Cover Top	电机顶壳	1
17	164B-17	Terminal Box Liid	接线盒顶盖	1
18	164B-18	Endpanel D.E.	接线盒前盖	1
19	164B-19	Endpanel N.D.E.	接线盒后盖	1
20	164B-20	Side Panel(AVR)	接线盒右侧盖 (AVR)	1
21	164B-21	Side Panel	接线盒左侧盖	1
22	164B-22	Main Terminal Panel	接线端子排	1
23	164B-23	Terminal Link	端子短接板	1
24	164B-24	Main Rectifier Assembly-Forward	上整流桥	1
25	164B-25	Main Rectifier Assembly-Reverse	下整流桥	1
26	164B-26	Varistor	变阻器	1
27	164B-27	Diode Reverse Polarity	反向二极管	1
28	164B-28	Diode Forward Polarity	正向二极管	1
29	9.20.01.0027	AVR(AS440)	AVR(AS440)	1
30	164B-30	AVR Mounting Plate	AVR固定板	1
31	164B-31	AVR Mounting Bracket	AVR固定条	1
32	164B-32	AVM	AVM	1
33	164B-33	Fan Hub	风扇连接盘	1
34	164B-34	Fan	风扇	1
35	164B-35	Fan Securing Screw	风扇链接螺栓	4
36	164B-36	current transformation	电流互感器 (50/5)	3

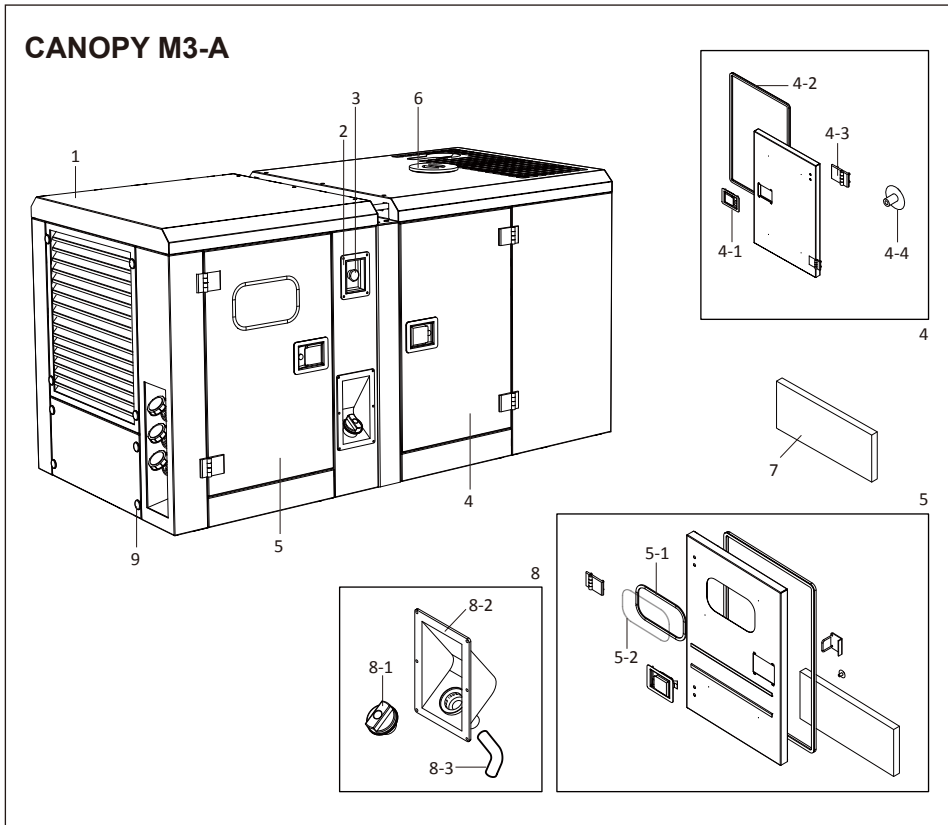

POS	REF	DESCRIPTION	配件	QTY
1	M3-A01	Canopy(2200mm×950mm×1050mm)	罩壳(2200mm × 950mm × 1050mm)	1
2	M3-A02	E-stop box	急停按钮盒	1
3	M3-A03	E-stop button	急停按钮	1
4	M3-A04	Door ASSY(2200mm×950mm×1050mm)	罩壳门总成(2200mm × 950mm × 1050mm)	3
4-1	M3-A04-1	Door lock	罩壳门锁	4
4-2	M3-A04-2	Door rubber seal	罩壳门封条	4
4-3	M3-A04-3	Door Chain	罩壳门铰链	8
4-4	M3-A04-4	Foam screw cap	海绵固定盖	32
5	M3-A05	Window glass and rubber seal	视窗门总成(2200mm × 950mm × 1050mm)	1
5-1	M3-A05-1	Window rubber seal	视窗封条	1
5-2	M3-A05-2	Window glass (244mm×134mm×3mm)	视窗门有机玻璃板(244mm × 134mm × 3mm)	1
	M3-A05-3	Window glass (244mm×284mm×3mm)	视窗门有机玻璃板(244mm × 284mm × 3mm)	1
6	M3-A06	Coolant filling up cap	加水口盖	1
7	M3-A07	Foam assy	成套海绵	1
8	M3-A08	Fuel filling assy	加油口盒总成	1
8-1	M3-A08-1	Fuel filling cap	加油口盖	1
8-2	M3-A08-2	Fuel filling box	加油口盒	1
8-3	M3-A08-3	Fuel filling pipe	加油口橡胶管	1
9	M3-A09	Rubber seal cap	橡胶塞	16

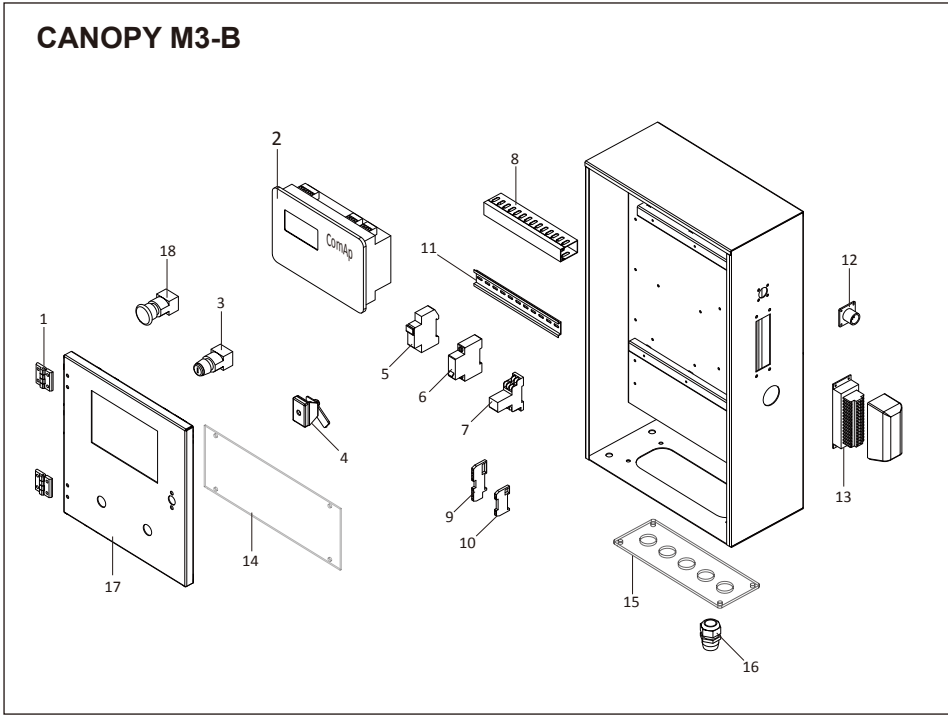

M3-B05-1



M3-B07-1



M3-B18



M3-B19



M3-B20



M3-B21

POS	REF	DESCRIPTION	配件	QTY
1	M3-B01	Control box door chain	铰链	2
2	M3-B02	Controller model (IL-NT MRS10)	控制模块(IL-NT MRS10)	1
2-1	M3-B02-1	Controller model (IL-NT MRS16)	控制模块(IL-NT MRS16)	1
3	M3-B03	Start lock	钥匙开关	1
4	M3-B04	Control box door lock	柜锁	1
5	M3-B05	Fuse holder	熔断器座	3
5-1	M3-B05-1	Fuse 4A	陶瓷管保险丝4A	3
6	M3-B06	Air breaker C10A	高分段小型断路器C10A	1
7	M3-B07	Relay holder	中间继电器座	4
7-1	M3-B07-1	Relay	继电器	4
8	M3-B08	Wire duct	配线槽	1
9	M3-B09	Terminal holder 4 pole	端子排 (大) 4孔	4
10	M3-B10	Terminal holder 2 pole	端子排 (小)	26
11	M3-B11	Rail 3.5mm	导轨(3.5mm)	1
12	M3-B12	Three Pins connector with ATS panel	三芯航空插座	1
13	M3-B13	Heavy duty connector (24 Pin)	重载插件(24芯)	1
14	M3-B14	Glass plate	有机玻璃板	1
15	M3-B15	Glass plate (280x100x5)	有机玻璃板(带5孔)	1
16	M3-B16	cable harness connector (PG29)	波纹管接头(PG29)	5
17	M3-B17	Control box door(COMAP IL-NT)	控制箱门(COMAP IL-NT)	1
	M3-B17-1	Control box door(DSE 6020)	控制箱门(DSE 6020)	1
18	M3-B18	E-stop	急停按钮	1
19	M3-B19	IP67 protection breaker box	防水开关盒罩	1
20	M3-B20	cable harness	线束	1
21	M3-B21	connector (3 phase 5 Pins)	接线柱 (三相五线)	1

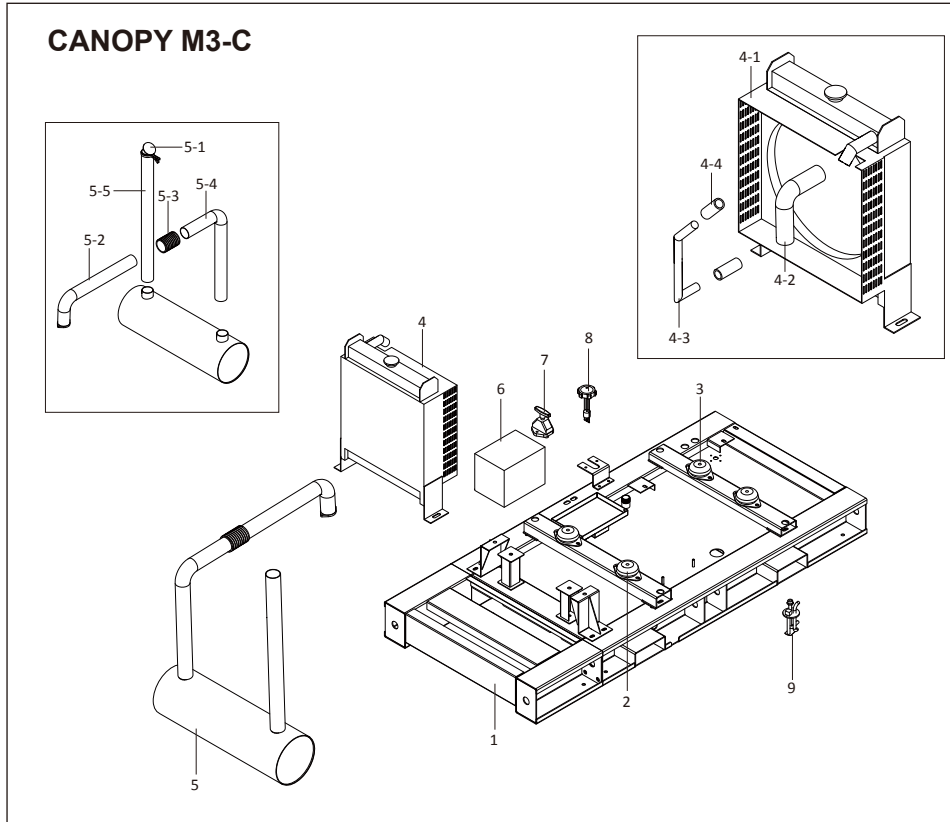

POS	REF	DESCRIPTION	配件	QTY
1	M3-C01	HY4102 base frame	底座焊接件(2200mm × 950mm × 180mm)	1
2	M3-C02	Engine shock pad	发动机减震垫	2
3	M3-C03	Alternator shock pad	发电机减震垫	2
4	M3-C04	Radiator ASSY	散热器总成	1
4-1	M3-C04-1	Radiator 50°	散热器(50度)	1
4-2	M3-C04-2	Silicon pipe	硅胶直角管	1
4-3	M3-C04-3	Stanless steel pipe	不锈钢进水弯管	1
4-4	M3-C04-4	Silion pipe	硅胶直管	2
5	M3-C05	Muffler ASSY	消声器总成	1
5-1	M3-C05-1	Muffler cap	防雨帽	1
5-2	M3-C05-2	Intake flange pipe	进气法兰弯管	1
5-3	M3-C05-3	metal bellows	波纹管	1
5-4	M3-C05-4	Intake pipe	进气弯管	1
5-5	M3-C05-5	Exhaust gas pipe	排气直管	1
6	M3-C06	Battery 55Ah	电瓶(L2-400MF/055-20)	1
7	M3-C07	Battery switch	电瓶开关(500A)	1
8	M3-C08	Mechanical fuel level	机械式油位计	1
9	M3-C09	Electrical fuel level sensor	油量传感器	1
10	M3-C10	Oil pressure sensor	油压传感器	1
11	M3-C11	Water temperature sensor	水温传感器	1
12	M3-C12	Engine stop solenoid	停车控制器	1
13	M3-C13	Engine cable harness	发动机线束	1
14	M3-C14	Oil sump output valve	油底壳放油阀	1
15	M3-C15	Start relay	启动继电器	1
16	M3-C16	Base frame fuel tank nut	底座油箱闷头	1
17	M3-C17	non valve	单向阀	1



M3-C10

M3-C11

M3-C12

M3-C13

M3-C14



M3-C15

M3-C16

M3-C17

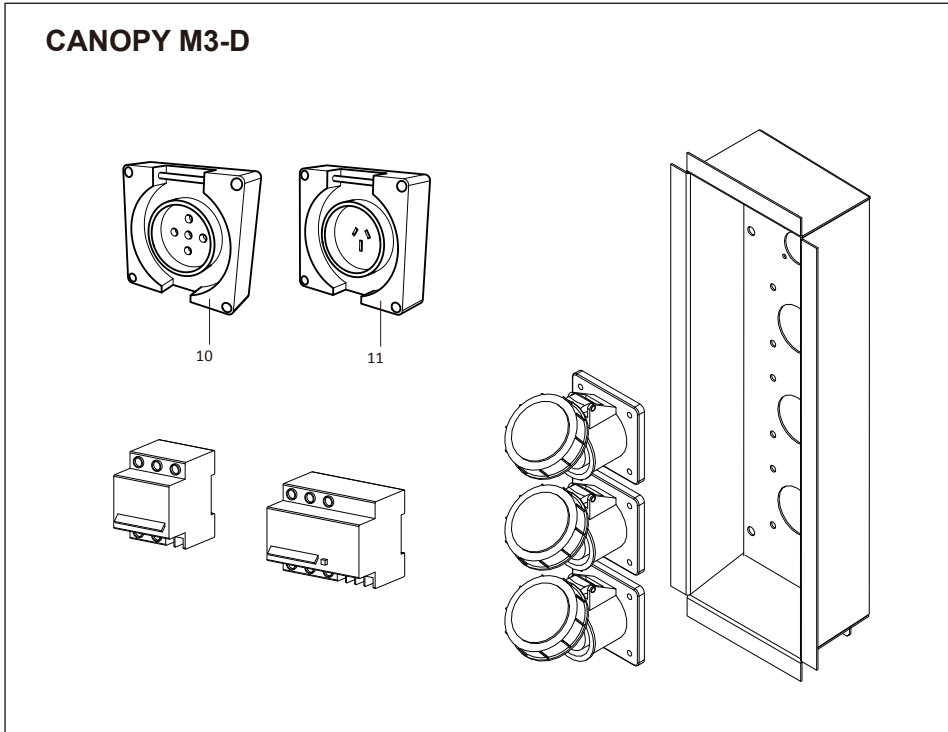

POS	REF	DESCRIPTION	配件	QTY
1	M3-D01	Leakge circuit Breaker 3P+N C40	主断路器3P+N 40A	1
2	M3-D02	Leakge circuit Breaker 1P+N C16	插座断路器1P+N 16A	3
3	M3-D03	Leakge circuit Breaker CDM1L125A-2310	主断路器CDM1L125A-2310	1
4	M3-D04	Leakge circuit Breaker 2P C32	插座断路器2P 32A	3
5	M3-D05	Leakge circuit Breaker 2P D100	主断路器 2P D100	1
6	M3-D06	Leakge circuit Breaker 3P+N C50	主断路器 3P+N C50	1
7	M3-D07	Europe socket 1-phase 32A IP44	欧式插座单相 32A IP44	1
8	M3-D08	Europe socket 1-phase 32A IP67	欧式插座单相 32A IP67	2
9	M3-D09	Europe socket 1-phase 16A IP67	欧式插座单相 16A IP67	3
10	M3-D10	Australian socket 3-phase 20A IP67	澳式插座三相 20A IP67	1
11	M3-D11	Australian socket 1-phase 15A IP67	澳式插座单相 15A IP67	1



M2-D07

M2-D08

M2-D09

